

Estriche $\leq 5 \text{ kN/m}^2$ Massiv-Holzdecken

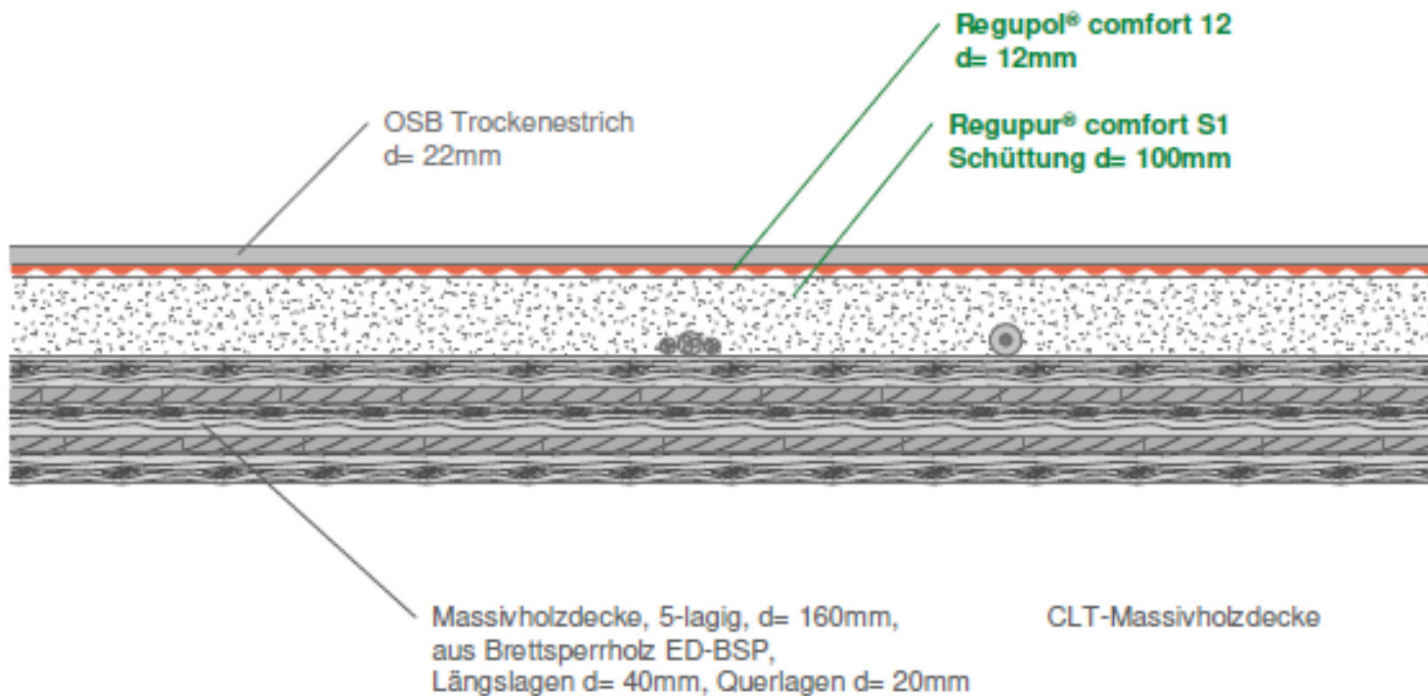

Prüfergebnisse:

$$L_{n,w} = 46 \text{ dB}$$

$$R_w = 70 \text{ dB}$$

Nullmessung:

$$L_{n,w} = 86 \text{ dB}$$

$$R_w = 39 \text{ dB}$$

Estriche $\leq 5 \text{ kN/m}^2$ Massiv-Holzdecken

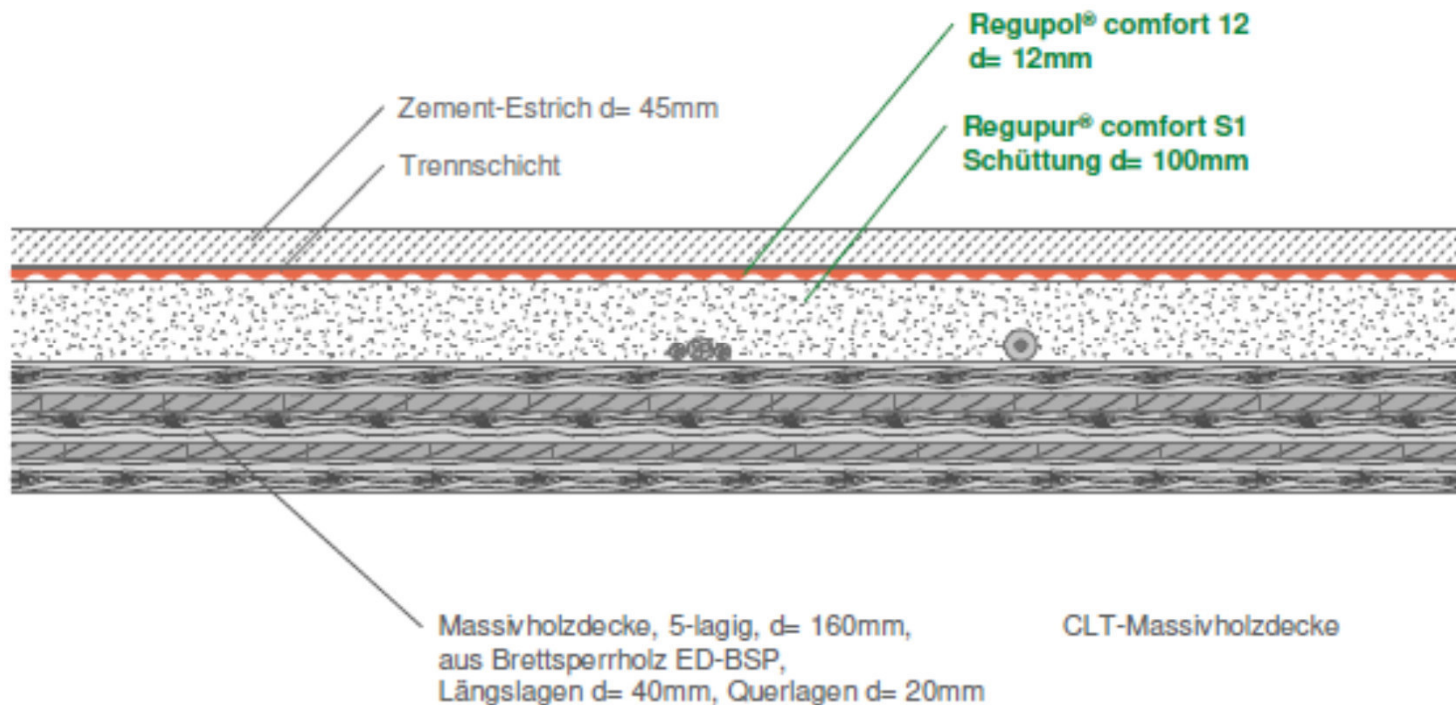

Prüfergebnisse:

$$L_{n,w} = 50 \text{ dB}$$

$$R_w = 70 \text{ dB}$$

Nullmessung:

$$L_{n,w} = 86 \text{ dB}$$

$$R_w = 39 \text{ dB}$$